

**DS-D4425FI-CKF
Full-Color LED Display**

DS-D4425FI-CKF is the new generation small pixel pitch indoor full-color LED display. LED video wall features in seamlessness, high brightness/contrast, wide viewing angle, and accurate color restoration, achieving good visual effect. It is widely used in places such as monitoring center, command center, conference room, report hall, and exhibition hall.

- Displays position prompt of signal cable connection, convenient for quick connection of display unit and trouble shooting
- Acquires network statuses of receiving cards to help handle network communication problems
- Network loop backup improves product stability
- Dual-program backup enables the backup program of receiving cards for upgrade and restoration when exception occurs during program upgrading
- Loads parameters from the screen
- Low gray scale multiplication technology ensures more exquisite images

▪ Specification

Model		DS-D4425FI-CKF
Cabinet	Pixel Configuration	SMD 3-IN-1 LED
	Pixel Pitch Category	P2.5
	Pixel Pitch	2.5 mm
	Modules Component	3 × 2
	Dimensions (W × H × D)	640 mm × 480 mm × 69 mm (25.19" × 18.90" × 2.71")
	Resolution	256 × 192
	Area	0.3072 m ²
	Weight	8.8 kg (19.4 lb.)
	Pixel Density	160000 dots/m ²
	Lamp Board Housing	no housing
	Cabinet Material	Die-cast aluminum
	Maintenance Method	Front maintenance for all components
	Cabinet Flatness	0.1 mm
	Protection Level	Front protection level IP5x
Display	White Balance Brightness	600 cd/m ²
	Color Temperature	3000 K to 10000 K adjustable
	Viewing Angle	Horizontal 160°, vertical 160°
	Contrast Ratio	≥ 5000:1
	Color Uniformity	≤ ± 0.003Cx , Cy
	Brightness Uniformity	≥ 97%
Processing Performance	Driving Method	Constant current driving
	Frame Frequency	60 Hz
	Refresh Rate	3840 Hz
	Grey Level	16 bit
	Display Color	281 trillion
Power	Power Supply	200 to 240 VAC
	Max. Consumption	≤ 600 W/m ²
	Average Consumption	≤ 200 W/m ²
Working Environment	Working Temperature	-10 °C to 40 °C (14 °F to 104 °F)
	Working Humidity	10% to 80%RH
	Storage Humidity	10% to 80%RH
	Storage Temperature	-20 °C to 60 °C (-4 °F to 140 °F)
General	Gross Weight	45 kg (99.21 lb.)
	Package Dimension (W × H × D)	784 mm × 741 mm × 800 mm (30.87" × 29.17" × 31.50") 4-in-1
	Lifespan	Lamp 100,000 hours

▪ **Available Model**

DS-D4425FI-CKF

▪ **Typical Application**

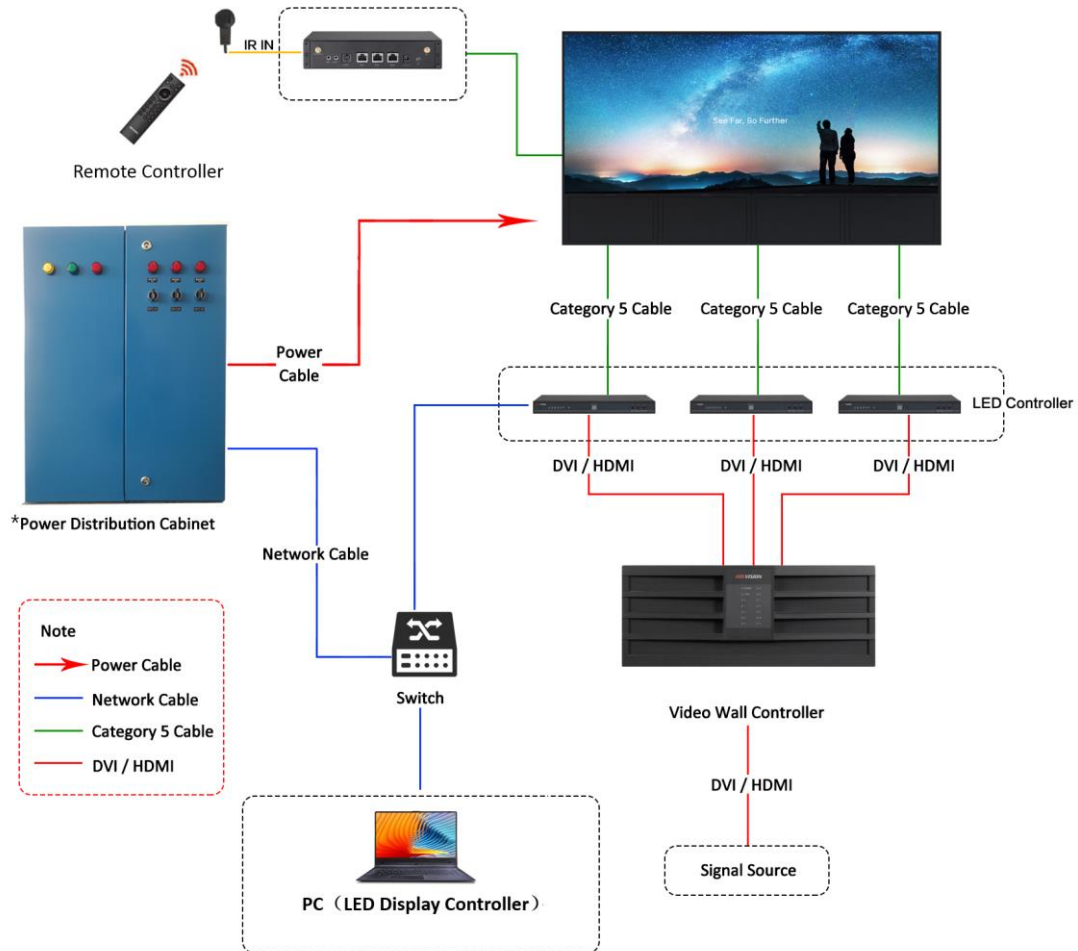

▪ **Dimension**

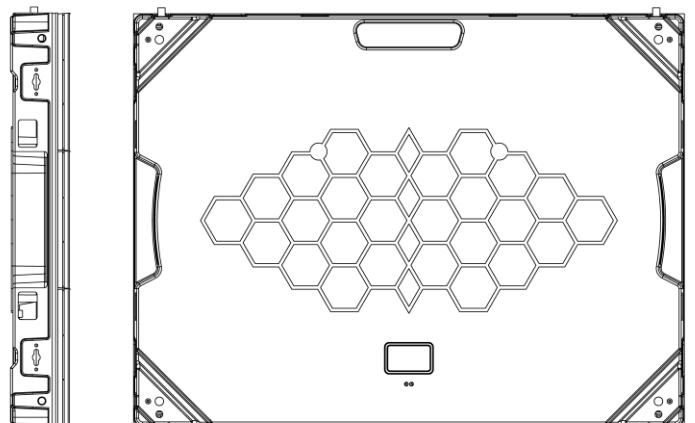
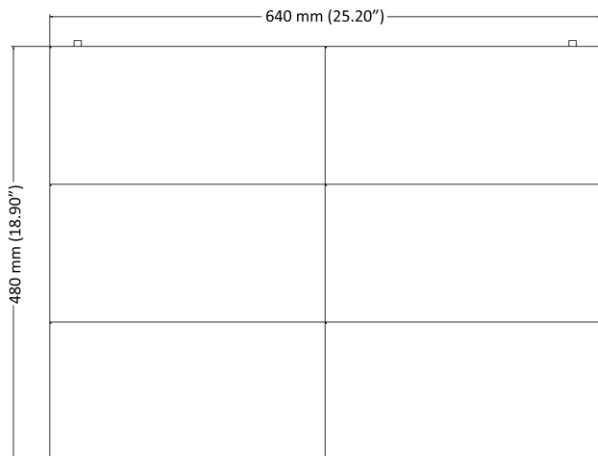

Unit: mm/inch