

**DS-D4415FI-CKF  
Full-Color LED Display**

DS-D4415FI-CKF is the new generation small pixel pitch indoor full-color LED display. LED video wall features in seamlessness, high brightness/contrast, wide viewing angle, and accurate color restoration, achieving good visual effect. It is widely used in places such as monitoring center, command center, conference room, report hall, and exhibition hall.

- Displays position prompt of signal cable connection, convenient for quick connection of display unit and trouble shooting
- Acquires network statuses of receiving cards to help handle network communication problems
- Network loop backup improves product stability
- Dual-program backup enables the backup program of receiving cards for upgrade and restoration when exception occurs during program upgrading
- Loads parameters from the screen
- Low gray scale multiplication technology ensures more exquisite images

## ▪ Specification

	Model	DS-D4415FI-CKF
<b>Cabinet</b>	Pixel Configuration	SMD 3-IN-1 LED
	Pixel Pitch Category	P1.53
	Pixel Pitch	1.538 mm
	Modules Component	3 × 2
	Dimensions (W × H × D)	640 mm × 480 mm × 69 mm (25.19" × 18.90" × 2.71" )
	Resolution	416 × 312
	Area	0.3072 m <sup>2</sup>
	Weight	8.8 kg (19.4 lb.)
	Pixel Density	422500 dots/m <sup>2</sup>
	Lamp Board Housing	no housing
	Cabinet Material	Die-cast aluminum
	Maintenance Method	Front maintenance for all components
	Cabinet Flatness	0.1 mm
	Protection Level	Front protection level IP5X
<b>Display</b>	White Balance Brightness	600 cd/m <sup>2</sup>
	Color Temperature	3000 K to 10000 K adjustable
	Viewing Angle	Horizontal 160°, vertical 160°
	Contrast Ratio	≥ 5000:1
	Color Uniformity	≤ ± 0.003Cx , Cy
	Brightness Uniformity	≥ 97%
<b>Processing Performance</b>	Driving Method	Constant current driving
	Frame Frequency	60 Hz
	Refresh Rate	3840 Hz
	Grey Level	16 bit
	Display Color	281 trillion
<b>Power</b>	Power Supply	200 to 240 VAC
	Max. Consumption	≤ 600 W/m <sup>2</sup>
	Average Consumption	≤ 200 W/m <sup>2</sup>
<b>Working Environment</b>	Working Temperature	-10 °C to 40 °C (14 °F to 104 °F)
	Working Humidity	10% to 80%RH
	Storage Humidity	10% to 80%RH
	Storage Temperature	-20 °C to 60 °C (-4 °F to 140 °F)
<b>General</b>	Gross Weight	45 kg (99.21 lb.)
	Package Dimension (W × H × D)	784 mm × 741 mm × 800 mm (30.87" × 29.17" × 31.50") 4-in-1
	Lifespan	Lamp 100,000 hours

▪ **Available Model**

DS-D4415FI-CKF

▪ **Typical Application**

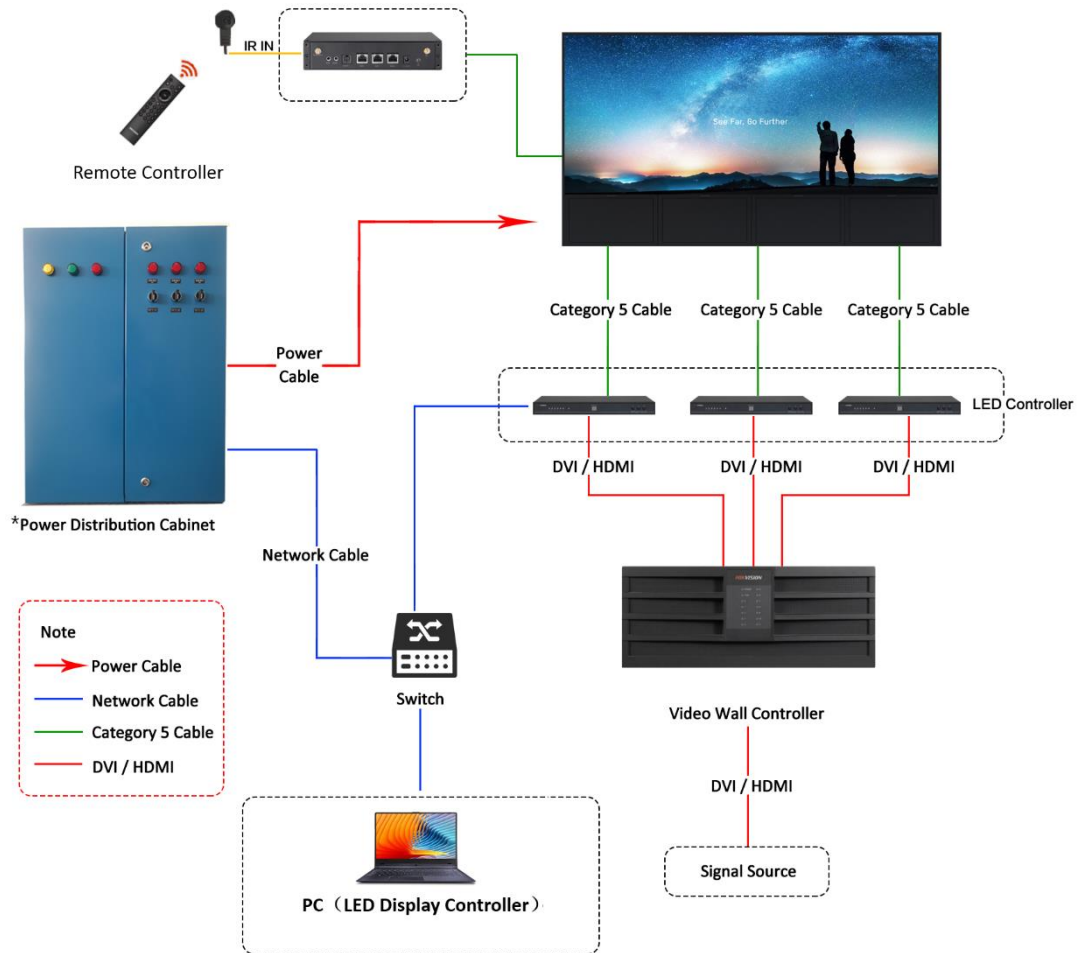

▪ **Dimension**

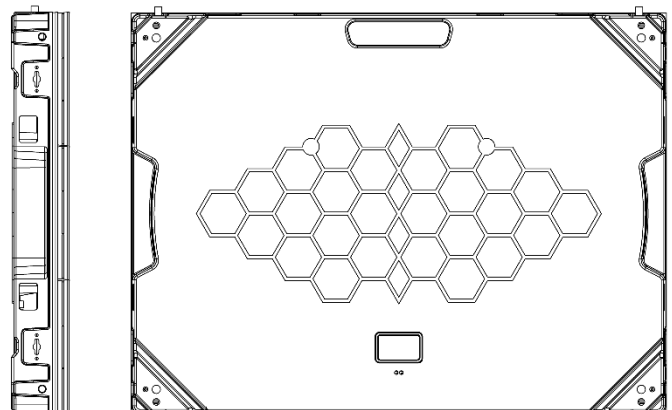
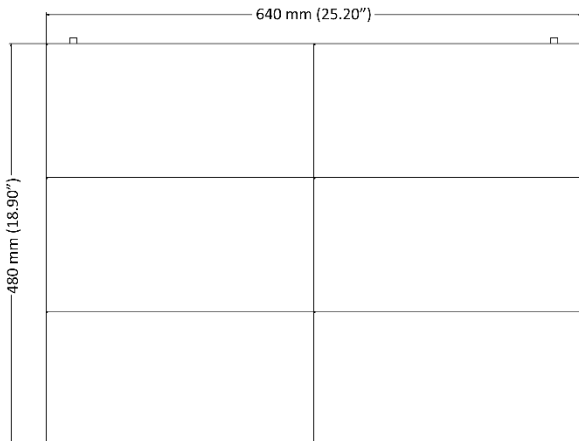
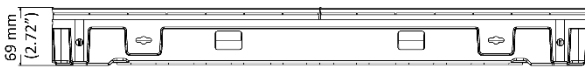

Unit: mm/inch